

Assembly Overview

With lock removed, the top of the Wall Mount Carrier can flex up, allowing the Upright to rotate and be loaded

Clear tube with tablets

Assembled Upright snap fits into Wall Mount Carrier

Secondary lock location to prevent usage/Slider from moving when locked

Lock prevents access to tablets and rotation of Upright

Spring loaded slider moves in channel to release tablets

Exploded

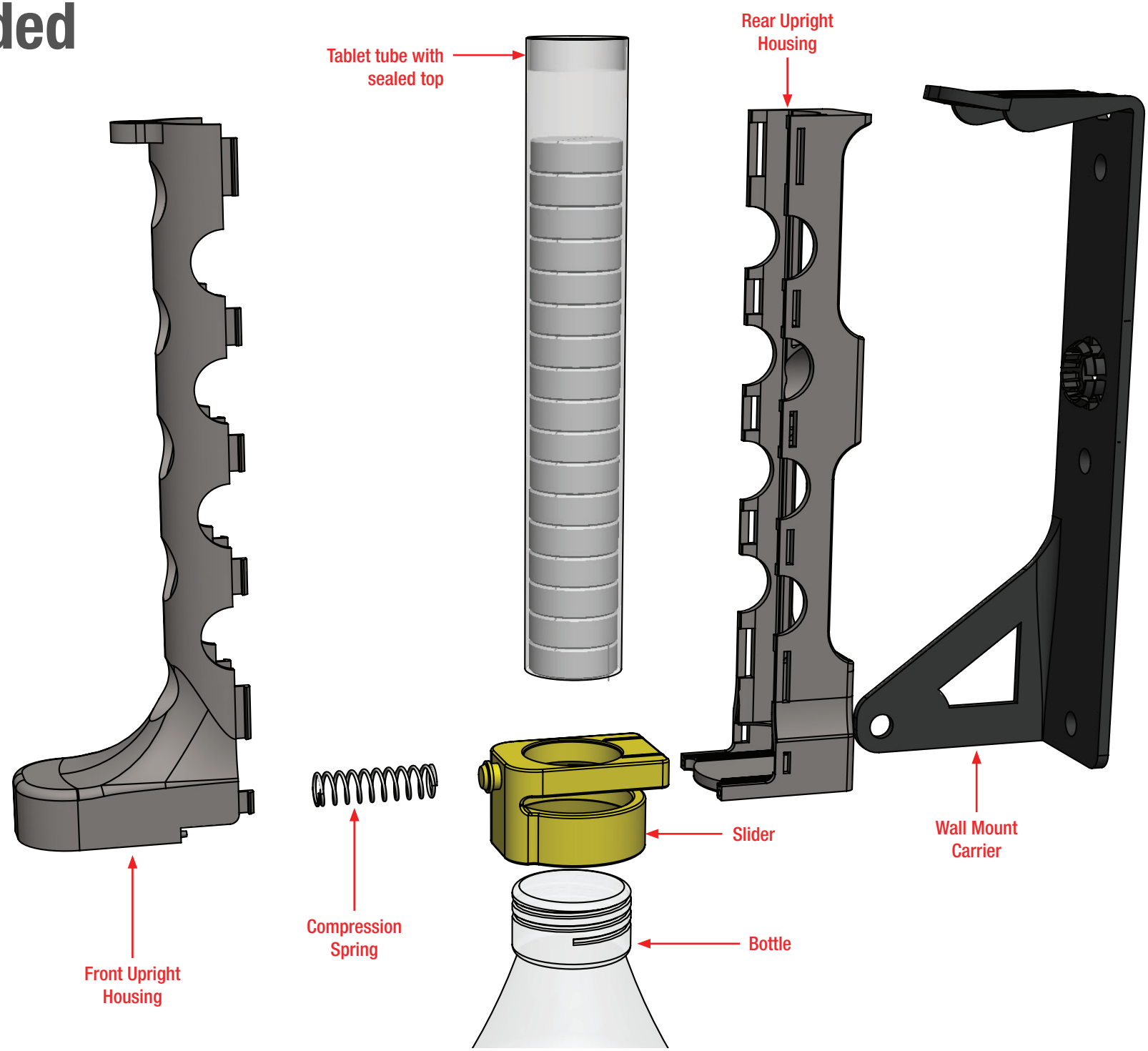

Assembly - At Rest

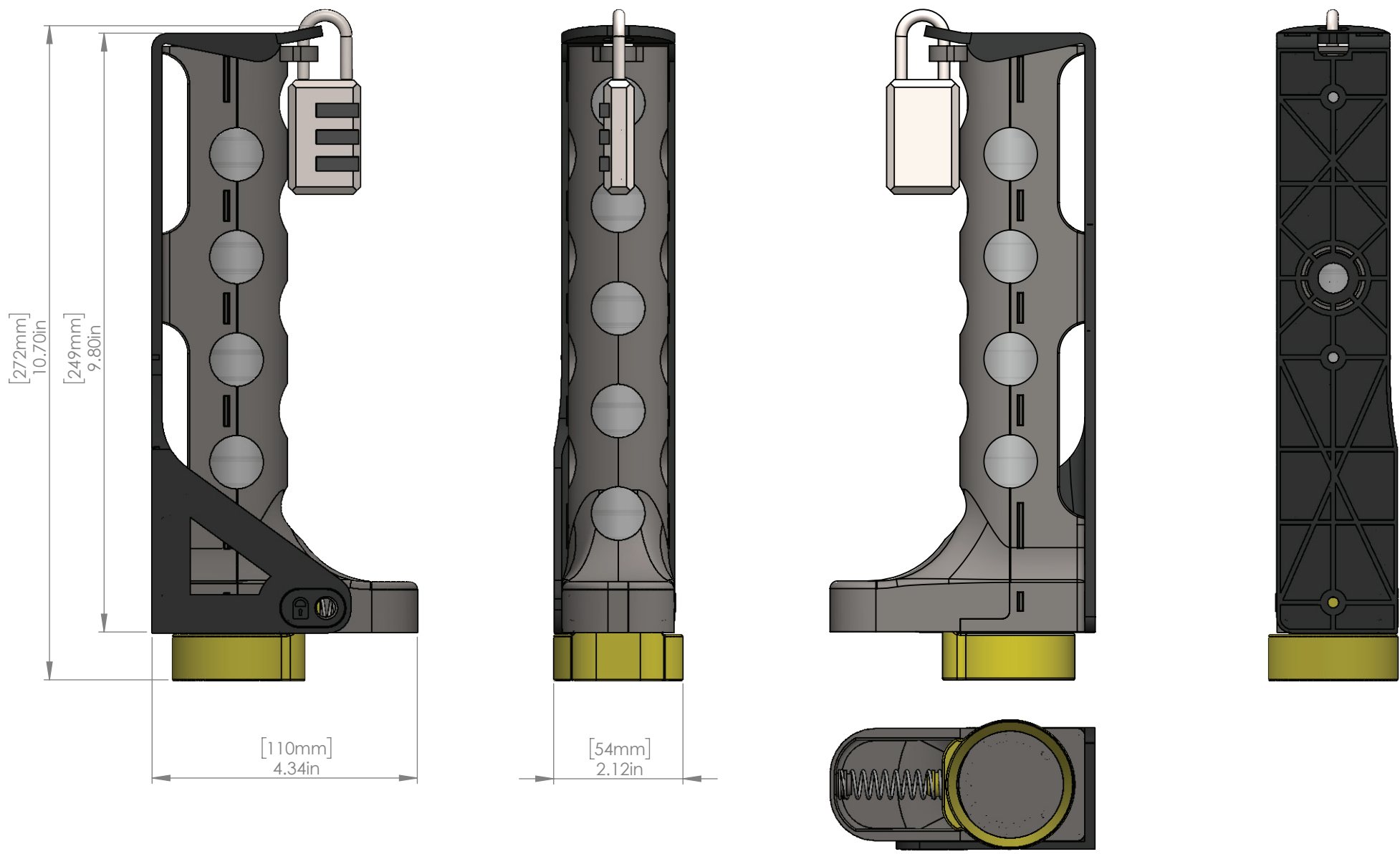

At Rest Cross Section

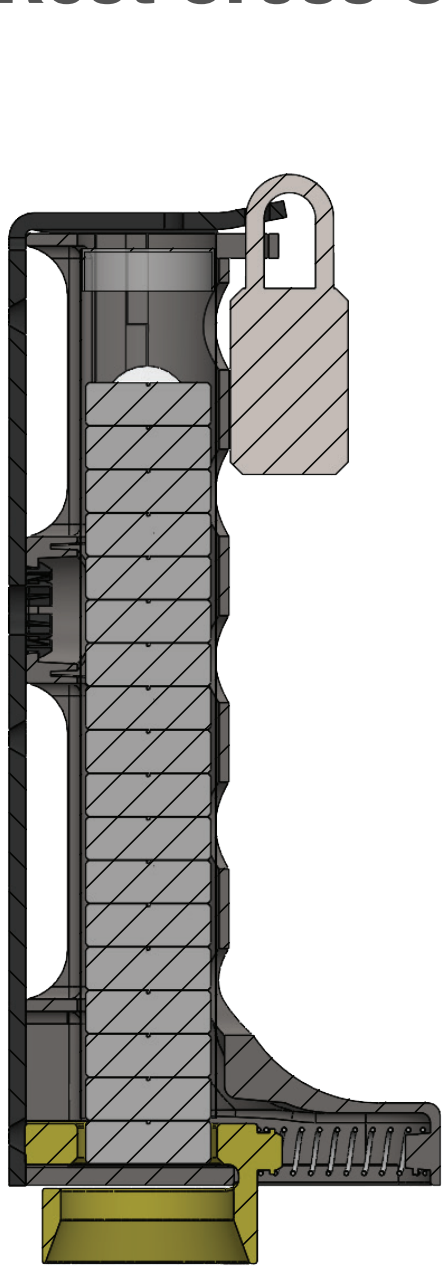

SECTION A-A
SCALE 1 : 2.25

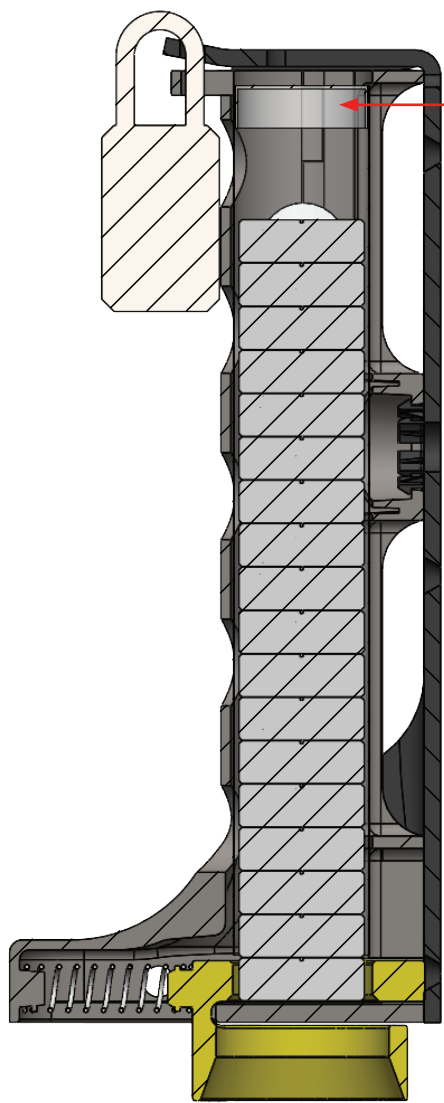
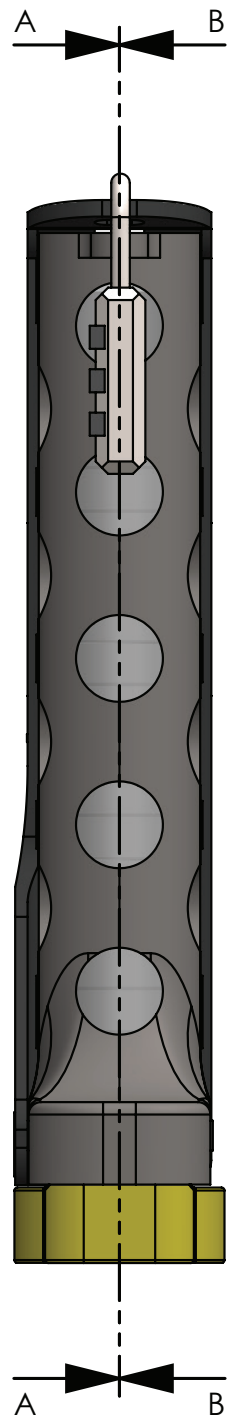

SECTION B-B
SCALE 1 : 2.25

Tube with sealed top

Snap fit rotational joint

Tablets gravity feed into Slider to be prepped for next ejection. Slider assembly keep the tablets unexposed to air until use.

Loaded Cross Section

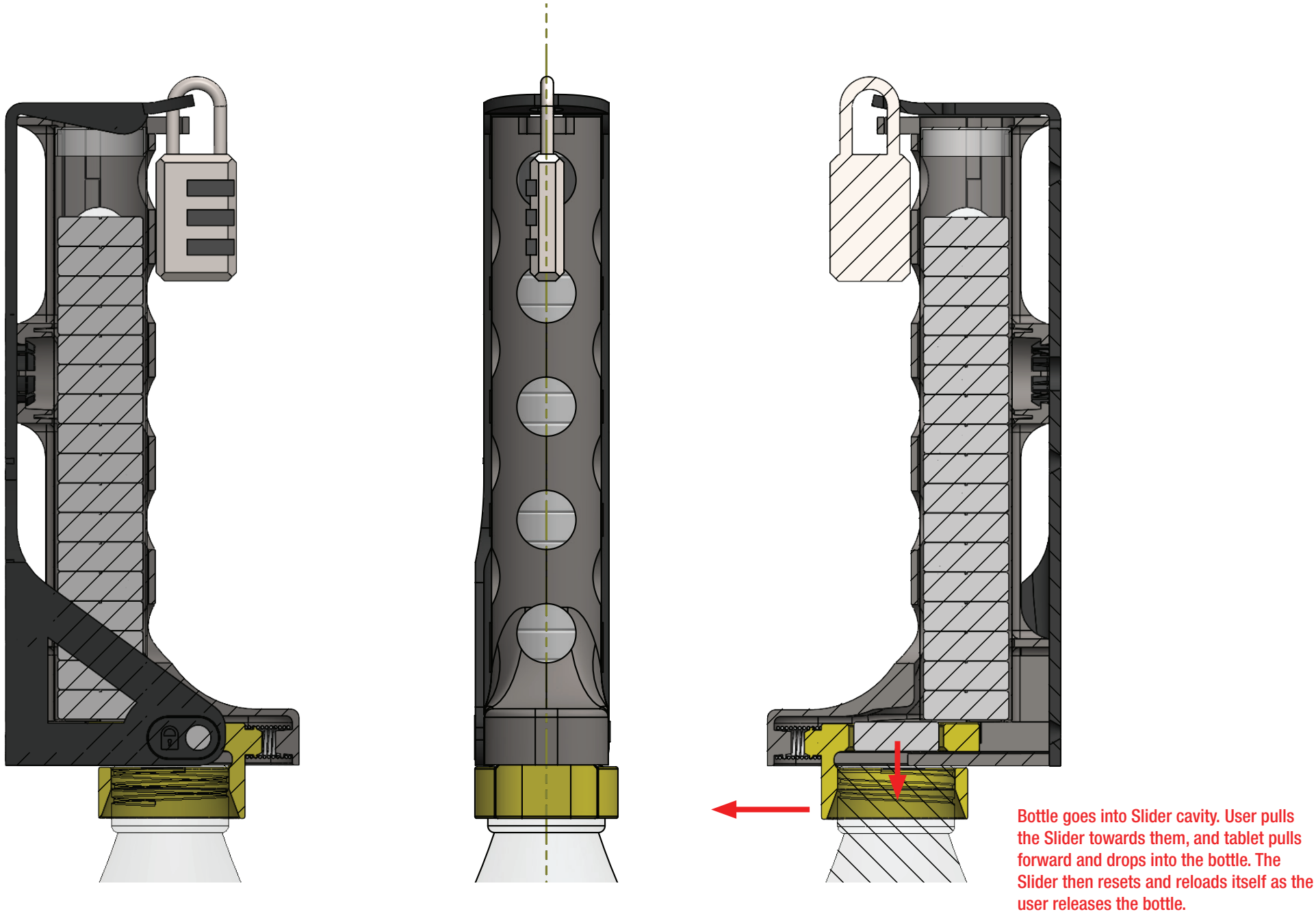

Small Tablet Exploded

Same Front Housing, Rear Housing, Wall Mount Carrier, and Slider with adapter pieces to accommodate smaller tube and tablets.

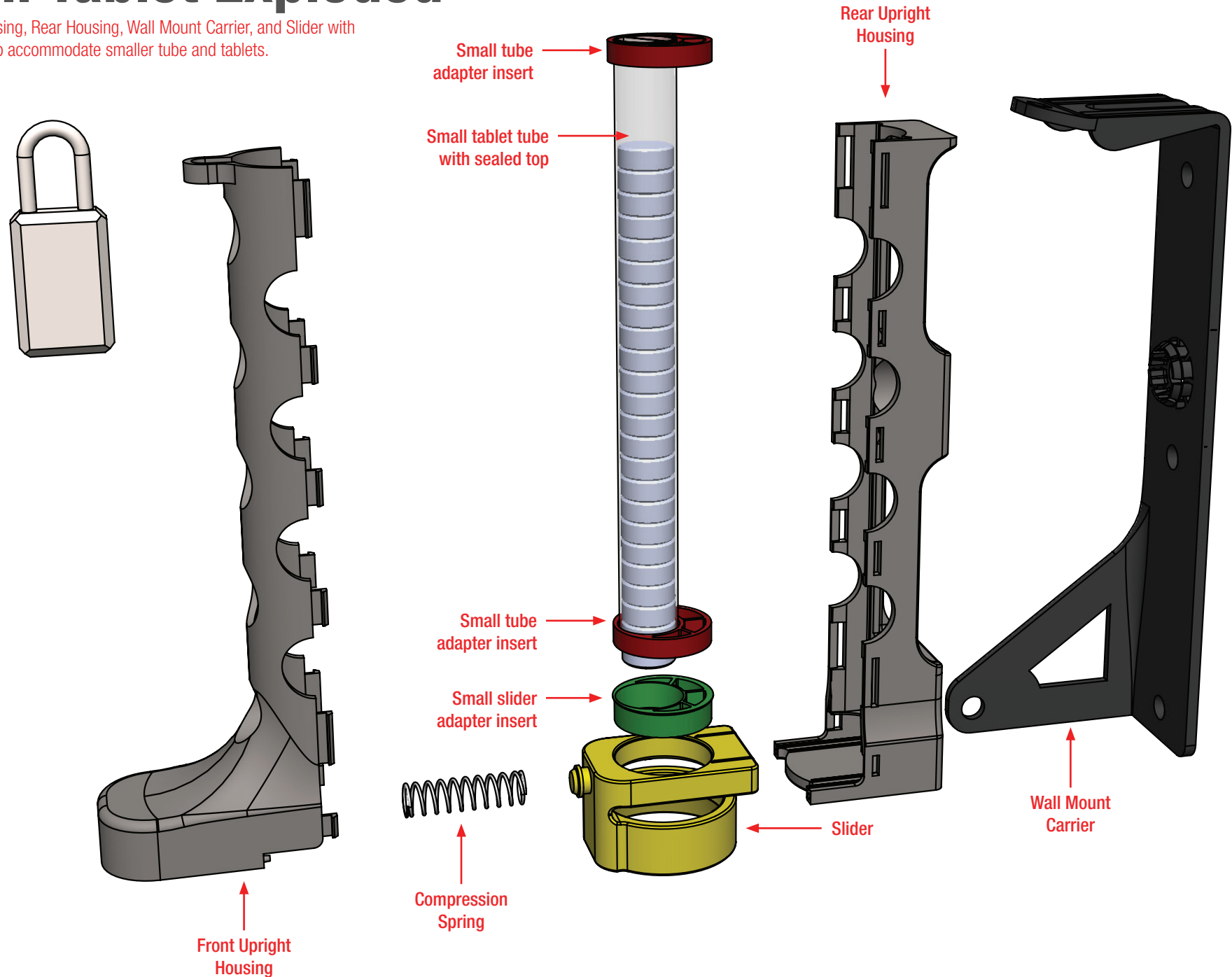

Small Tablet At Rest Cross Section

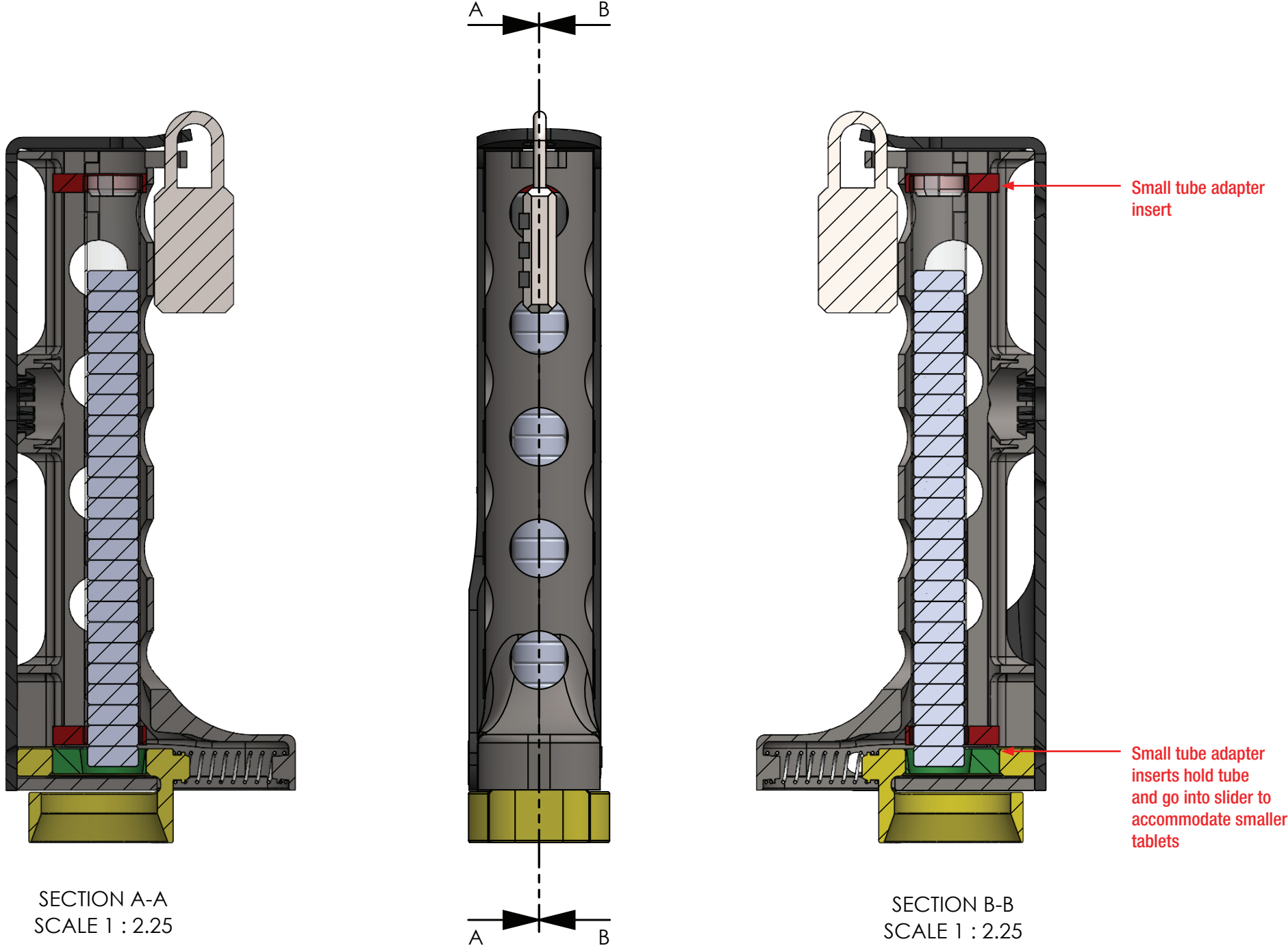

Rotational Feature

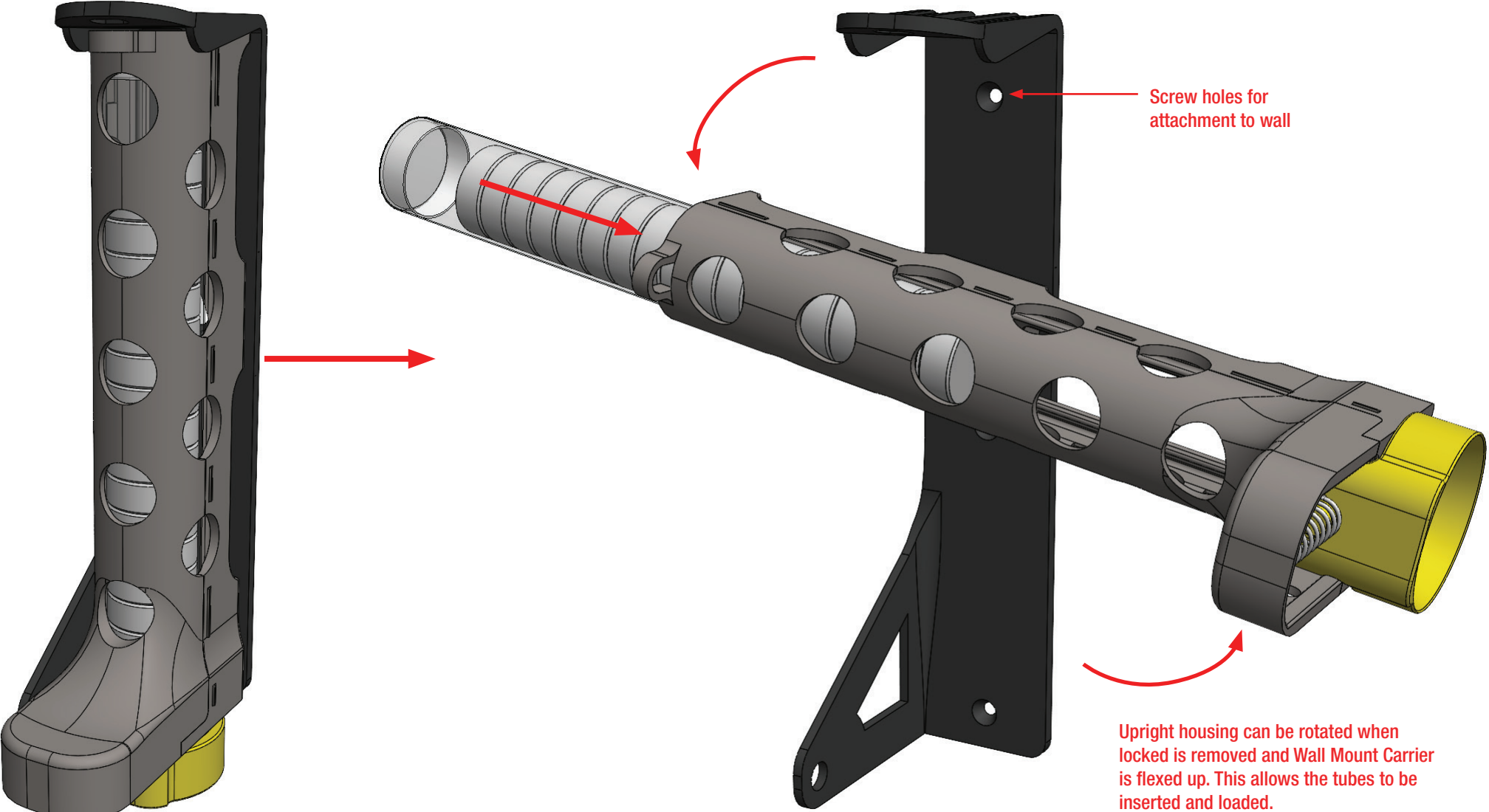

Dual Lock

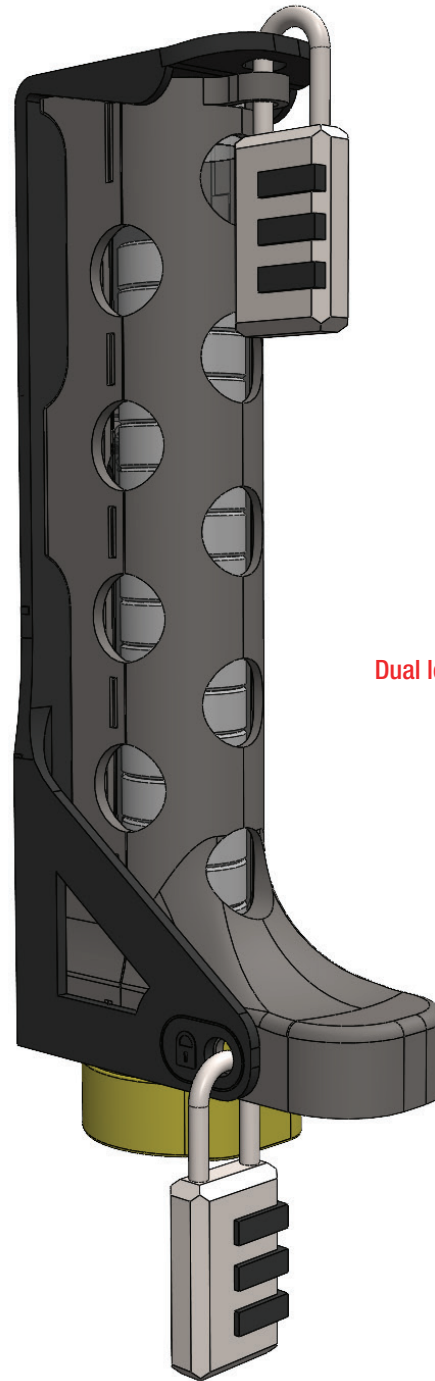

Dual locks would prevent tampering and use